

MARTIN COUNTY

MARTIN COUNTY

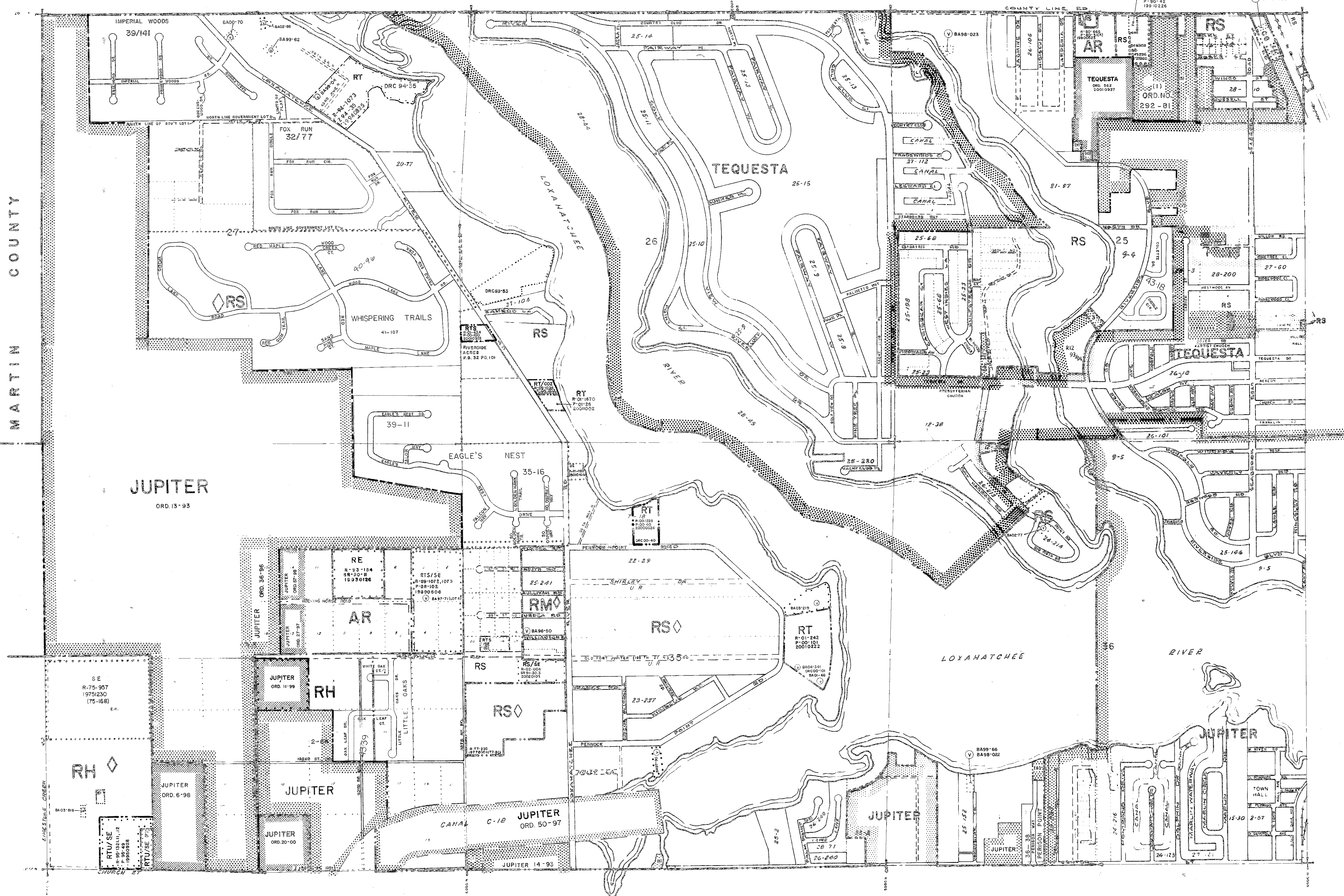

RESOLUTIONS	
11	ORD. NO. 292-81
12	ORD. NO. 417

RESOLUTIONS	
13	ORD. NO. 391-87
14	ORD. NO. 400-87
15	ORD. NO. 407-88
16	ORD. NO. 411-88
17	ORD. NO. 412-88
18	ORD. NO. 413-88
19	ORD. NO. 414-88
20	ORD. NO. 415-88
21	ORD. NO. 416-88
22	ORD. NO. 417-88
23	ORD. NO. 418-88
24	ORD. NO. 419-88
25	ORD. NO. 420-88
26	ORD. NO. 421-88
27	ORD. NO. 422-88
28	ORD. NO. 423-88
29	ORD. NO. 424-88
30	ORD. NO. 425-88
31	ORD. NO. 426-88
32	ORD. NO. 427-88
33	ORD. NO. 428-88
34	ORD. NO. 429-88
35	ORD. NO. 430-88
36	ORD. NO. 431-88
37	ORD. NO. 432-88
38	ORD. NO. 433-88
39	ORD. NO. 434-88
40	ORD. NO. 435-88
41	ORD. NO. 436-88
42	ORD. NO. 437-88
43	ORD. NO. 438-88
44	ORD. NO. 439-88
45	ORD. NO. 440-88
46	ORD. NO. 441-88
47	ORD. NO. 442-88
48	ORD. NO. 443-88
49	ORD. NO. 444-88
50	ORD. NO. 445-88
51	ORD. NO. 446-88
52	ORD. NO. 447-88
53	ORD. NO. 448-88
54	ORD. NO. 449-88
55	ORD. NO. 450-88
56	ORD. NO. 451-88
57	ORD. NO. 452-88
58	ORD. NO. 453-88
59	ORD. NO. 454-88
60	ORD. NO. 455-88
61	ORD. NO. 456-88
62	ORD. NO. 457-88
63	ORD. NO. 458-88
64	ORD. NO. 459-88
65	ORD. NO. 460-88
66	ORD. NO. 461-88
67	ORD. NO. 462-88
68	ORD. NO. 463-88
69	ORD. NO. 464-88
70	ORD. NO. 465-88
71	ORD. NO. 466-88
72	ORD. NO. 467-88
73	ORD. NO. 468-88
74	ORD. NO. 469-88
75	ORD. NO. 470-88
76	ORD. NO. 471-88
77	ORD. NO. 472-88
78	ORD. NO. 473-88
79	ORD. NO. 474-88
80	ORD. NO. 475-88
81	ORD. NO. 476-88
82	ORD. NO. 477-88
83	ORD. NO. 478-88
84	ORD. NO. 479-88
85	ORD. NO. 480-88
86	ORD. NO. 481-88
87	ORD. NO. 482-88
88	ORD. NO. 483-88
89	ORD. NO. 484-88
90	ORD. NO. 485-88
91	ORD. NO. 486-88
92	ORD. NO. 487-88
93	ORD. NO. 488-88
94	ORD. NO. 489-88
95	ORD. NO. 490-88
96	ORD. NO. 491-88
97	ORD. NO. 492-88
98	ORD. NO. 493-88
99	ORD. NO. 494-88
100	ORD. NO. 495-88

..... PUD BOUNDARIES  
 - - - - - DISTRICT BOUNDARIES  
 [Hatched] CORPORATE BOUNDARIES

The zoning category for the property indicated on this sheet may not be consistent with the property's Future Land Use designation under the Palm Beach County Comprehensive Plan. Please contact the Palm Beach County Planning Division at 100 Australian Avenue, West Palm Beach, FL 33406, (561) 233-5300, to confirm the property's Future Land Use designation and other relevant Comprehensive Plan requirements.

**PALM BEACH COUNTY, FLORIDA**  
**OFFICIAL ZONING DISTRICT MAP**  
 Scale 1" = 400' approx. Date May 1981  
 Quadrant 40 42D Sheet No. 25